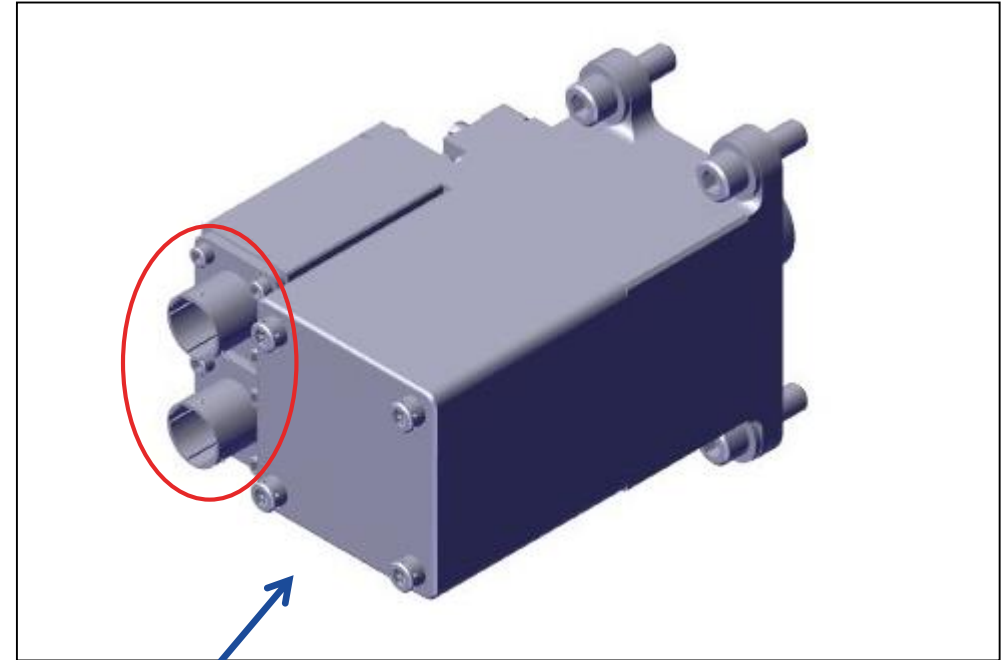

A330 APPU ATA 27

RTW 2023

LIEBHERR

Liebherr - Aerospace

OVERVIEW



APPU PN: 9028A0005-01

OVERVIEW

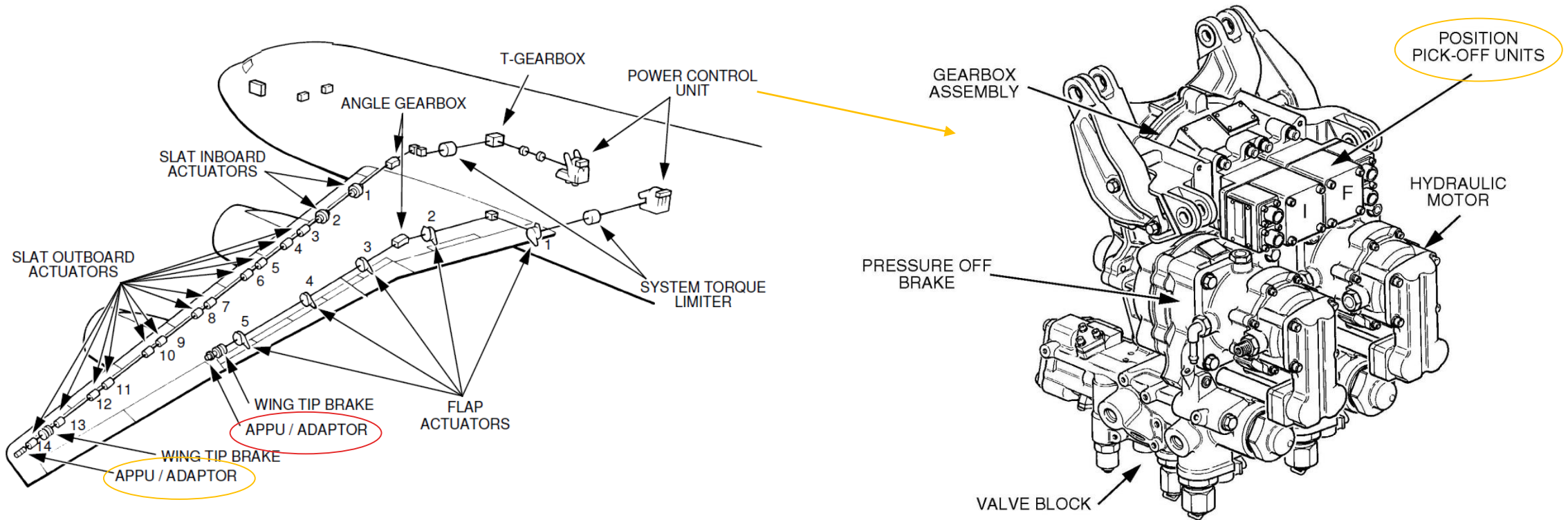

OVERVIEW

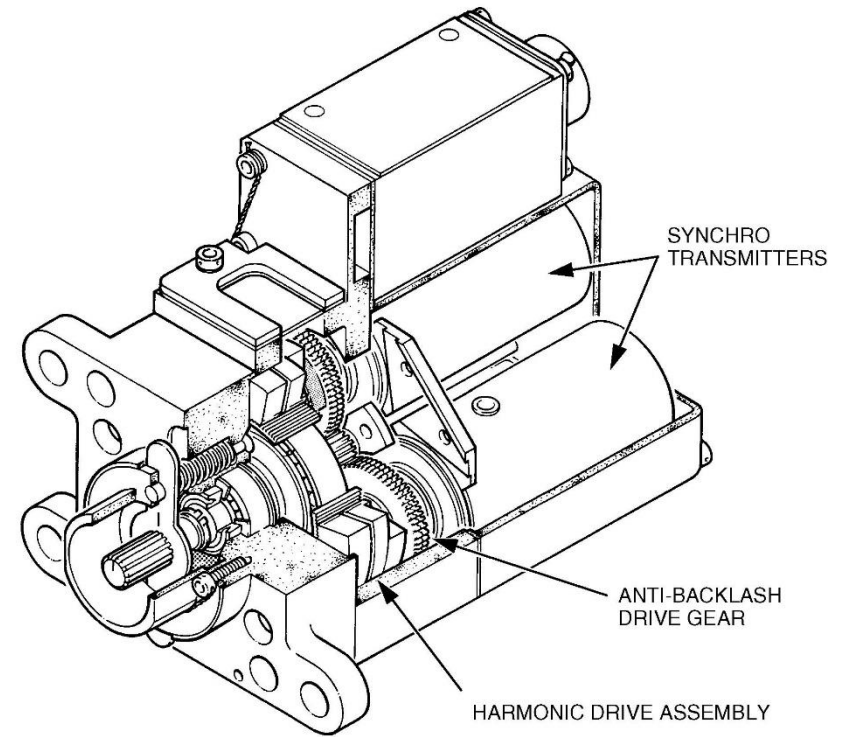
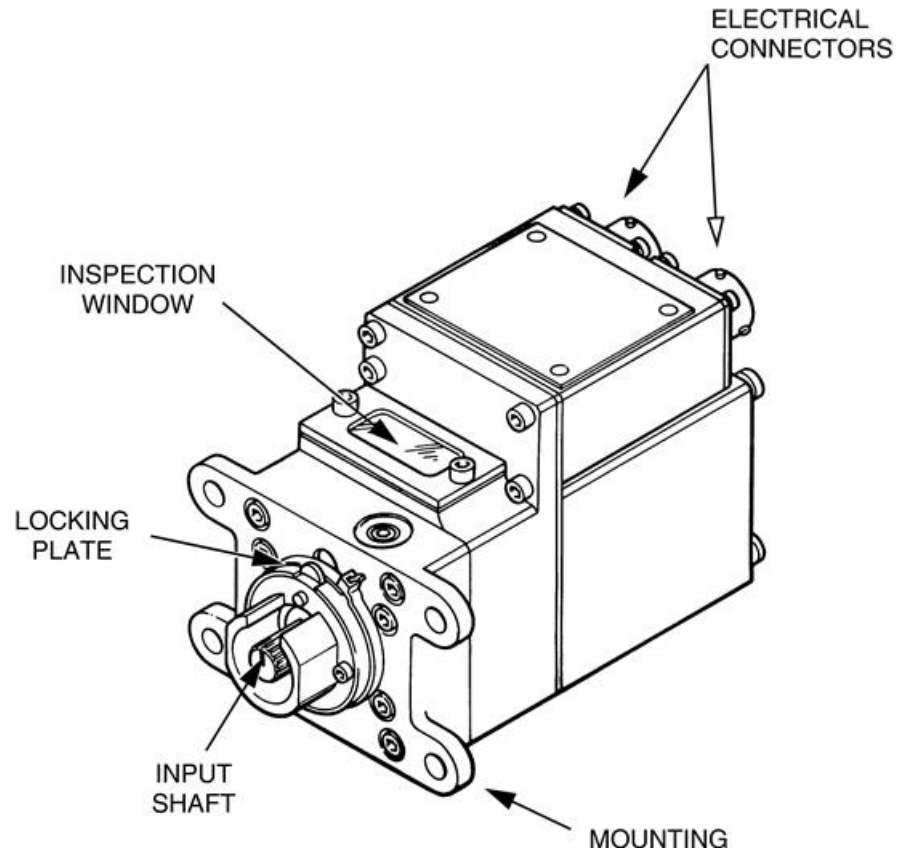

APPU – Ratcheting: Recap

- Flaps locked during approach on A/C delivered since DEC 2016
- ECAM warning F/CTL FLAPS LOCKED
- Root Cause:
 - Seal of (black anodized) connector insufficient
 - Low temp conditions: moisture inside harmonic drive freezes → ratcheting
 - Ratcheting causes offset between electrical vs. mechanical position → asymmetry

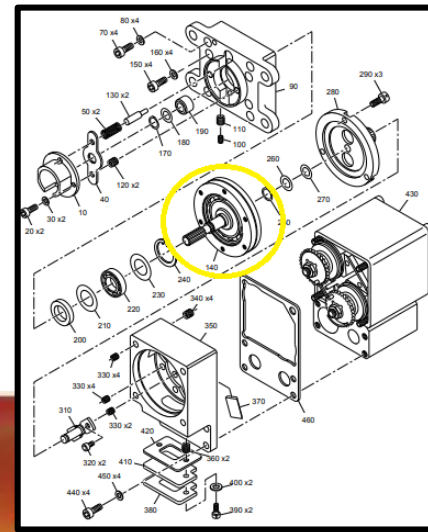
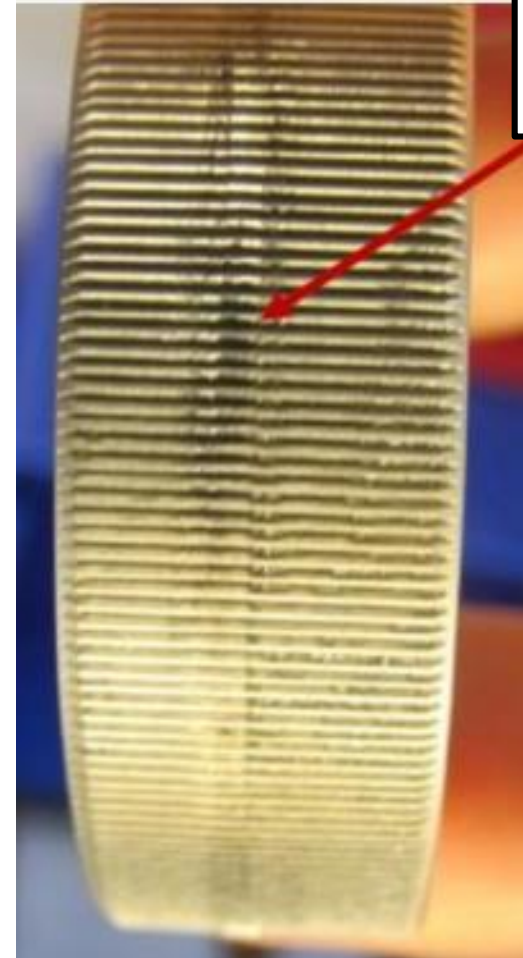

APPU - Ratcheting: Solution

➤ Back to the roots!

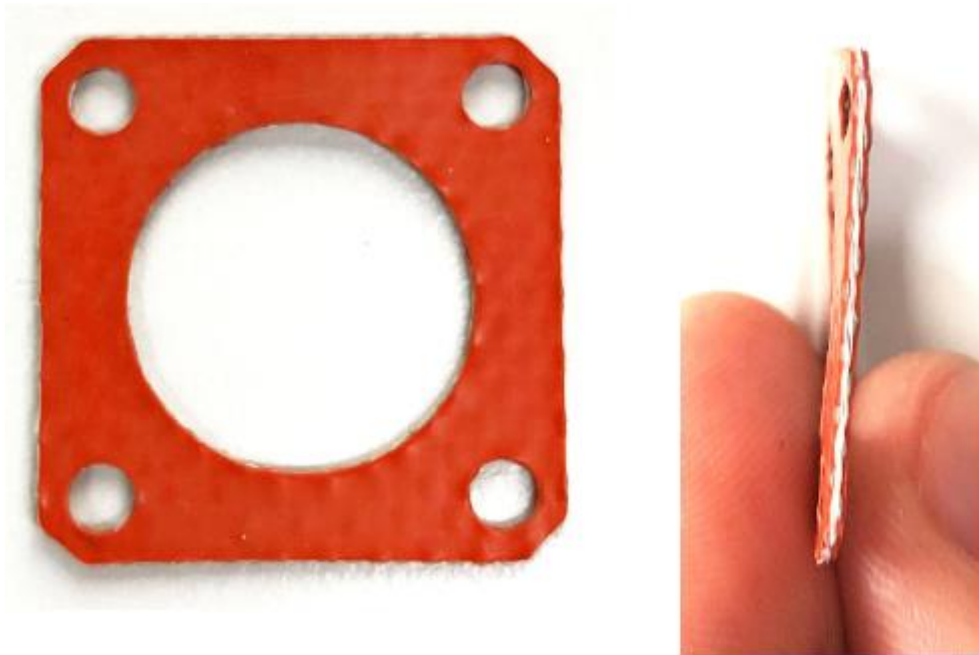

pre-mod connector gasket

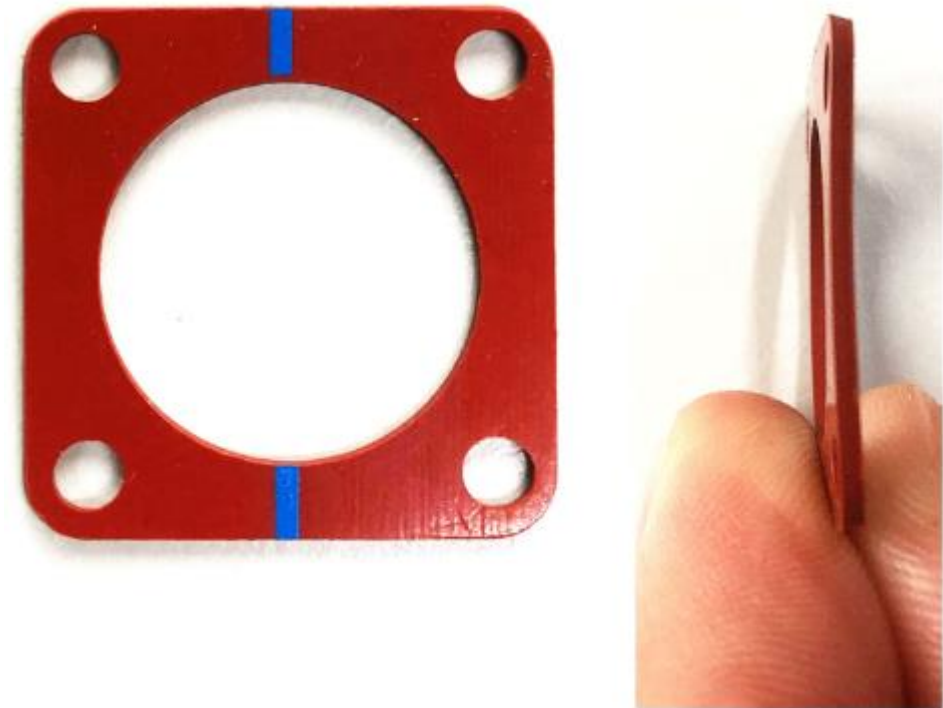

post-mod connector gasket

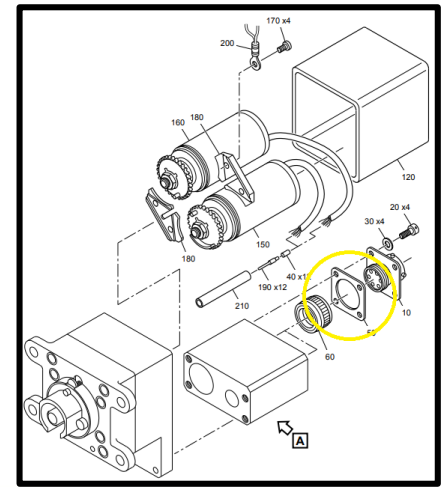

APPU - Ratcheting: Solution

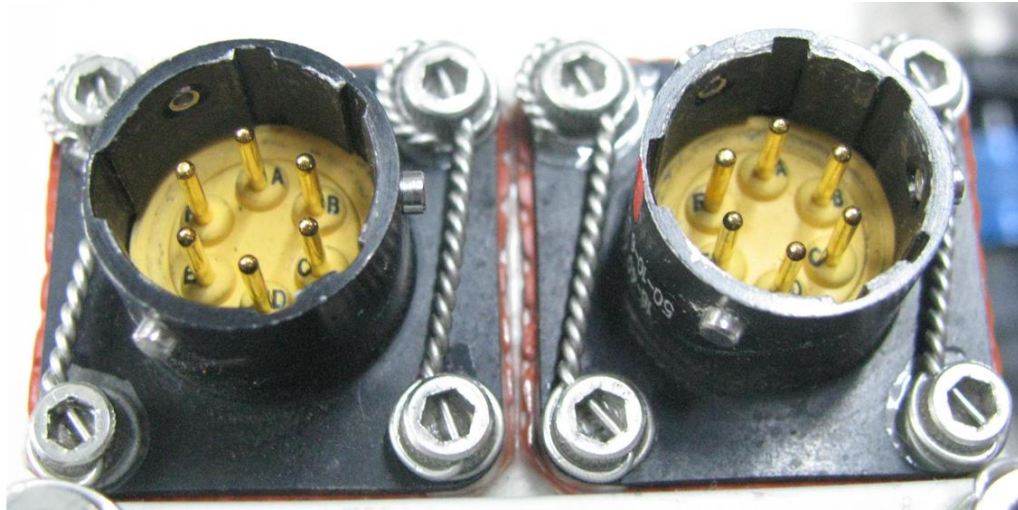
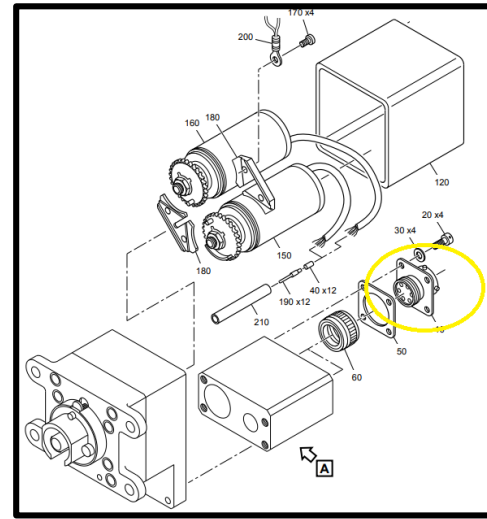

BLACK ANODIZED CONNECTOR
PNR: ASNE0053R10B6PW



NICKEL CONNECTOR
PNR: C23334Z3C7



TIMELINE

